



**316 The Cedars, Abbey Foregate, Shrewsbury, SY2 6BY**

1 bedroom ground floor apartment — £155,000 Leasehold

# 316 The Cedars, Abbey Foregate, Shrewsbury, SY2 6BY

Coopergreenpooks.co.uk

£155,000 Leasehold—1 bedroom ground floor apartment

Coopergreenpooks.co.uk/property/26531

A beautifully presented and individually designed ground floor retirement apartment, recently renovated to a high standard throughout, located within this purpose built development offering excellent facilities, just a short walk from the town centre.

## KEY FEATURES

- Entrance hall with useful storage
- Lovely open plan living/dining room with feature fireplace and views to front
- Re-fitted kitchen with integrated appliances
- Impressive master bedroom providing plenty of room for wardrobes and additional seating area
- Modern shower room complete with double length walk in cubicle
- uPVC double glazed windows and electric heating
- Lovely private communal grounds surround the Cedars and overlook woodland
- Private car park for residents and guest use
- Residents lounge and guest suite available
- There is also a visiting house manager available Mon-Fri 8am-4pm
- Furniture is available by separate negotiation

Cooper Green Pooks  
3 Barker Street  
Shrewsbury  
SY1 1QF

www.cgpooks.co.uk  
sales@cgpooks.co.uk  
01743 276666



## Ground Floor

Approx. 56.7 sq. metres (610.8 sq. feet)

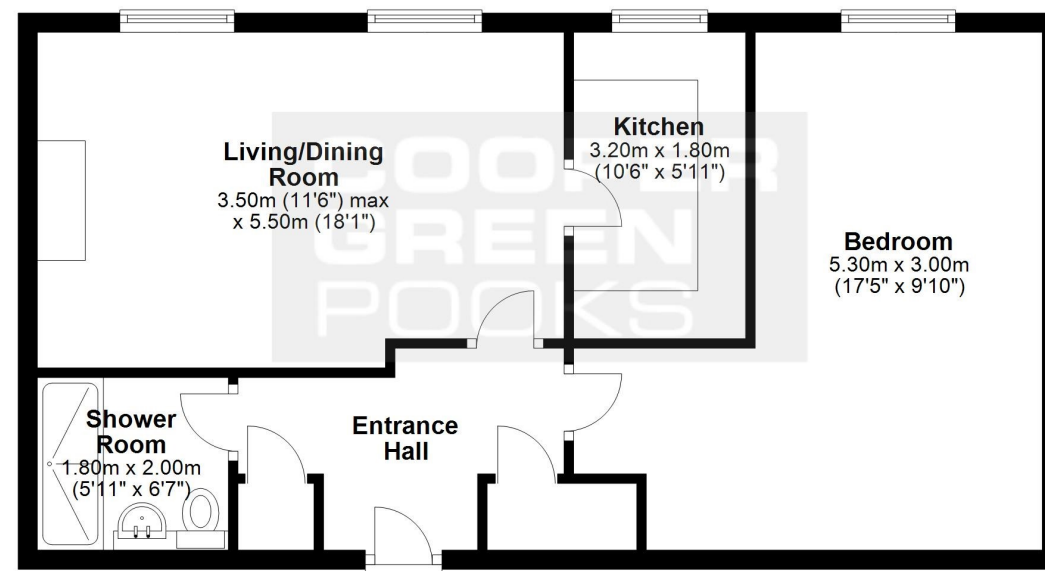

Total area: approx. 56.7 sq. metres (610.8 sq. feet)

We accept no responsibility for any mistake or inaccuracy contained within the floorplan. The floorplan is provided as a guide only and should be taken as an illustration only. The measurements, contents and positioning are approximations only and provided as a guidance tool and not an exact replication of the property.

Plan produced using PlanUp.







# 316 The Cedars, Abbey Foregate, Shrewsbury, SY2 6BY

£155,000 Leasehold—1 bedroom ground floor apartment

Coopergreenpooks.co.uk/property/26531

rightmove

onTheMarket.com

RICS  
Regulated by RICS

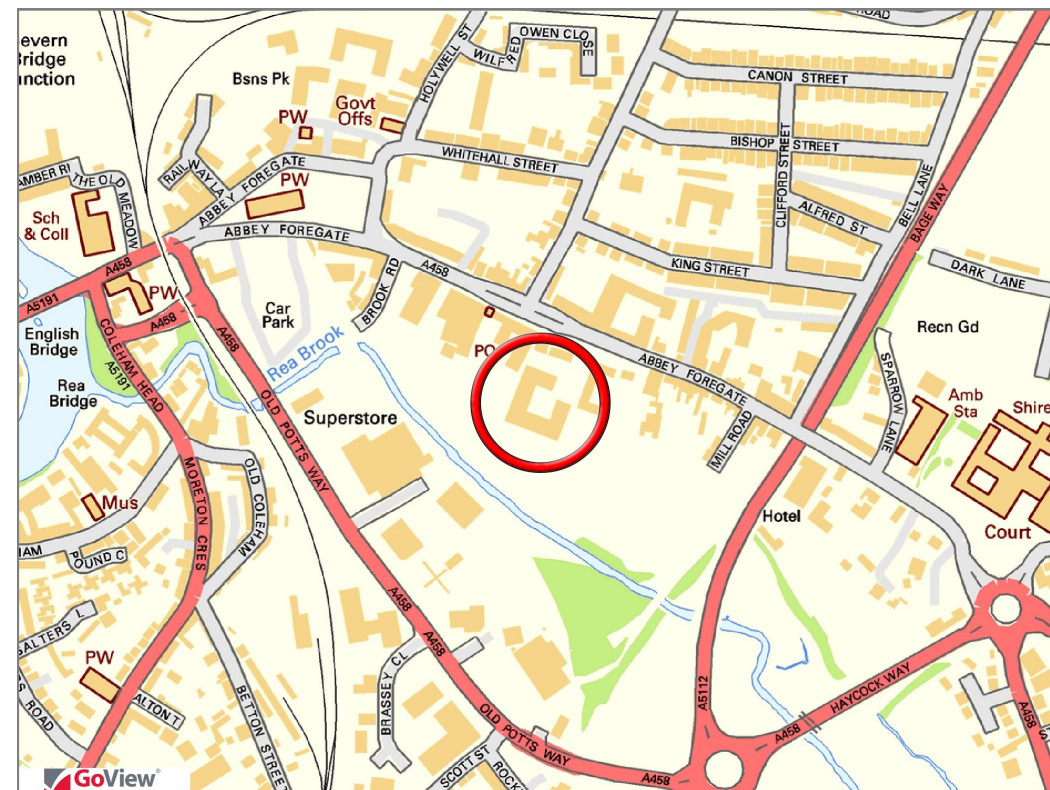
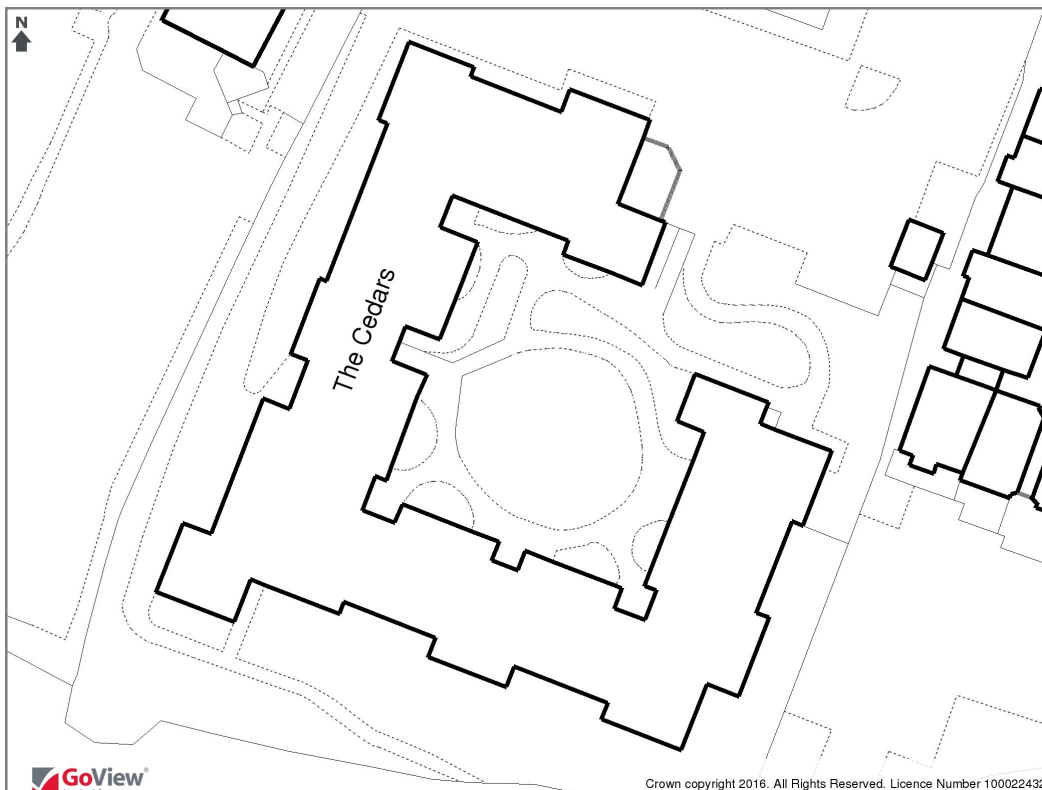

Tenure	Leasehold
Local Authority	Shropshire Council
Council Tax	Band C
EPC Band	TBC
Services	Mains water, electricity and drainage are connected
Lease	125 years from 1988
Service charge	£2160 pa

Expert mortgage advice available

3 Barker St, Shrewsbury SY1 1QF

Cooper Green Pooks  
01743 276666



Your home may be repossessed if you do not keep up repayments on your mortgage.

There may be a fee for mortgage advice. The actual amount you pay will depend upon your circumstances. The fee is up to 1% but a typical fee is 0.3% of the amount borrowed.

# 316 The Cedars, Abbey Foregate, Shrewsbury, SY2 6BY

Coopergreenpooks.co.uk

£155,000 Leasehold—1 bedroom ground floor apartment

Coopergreenpooks.co.uk/property/26531

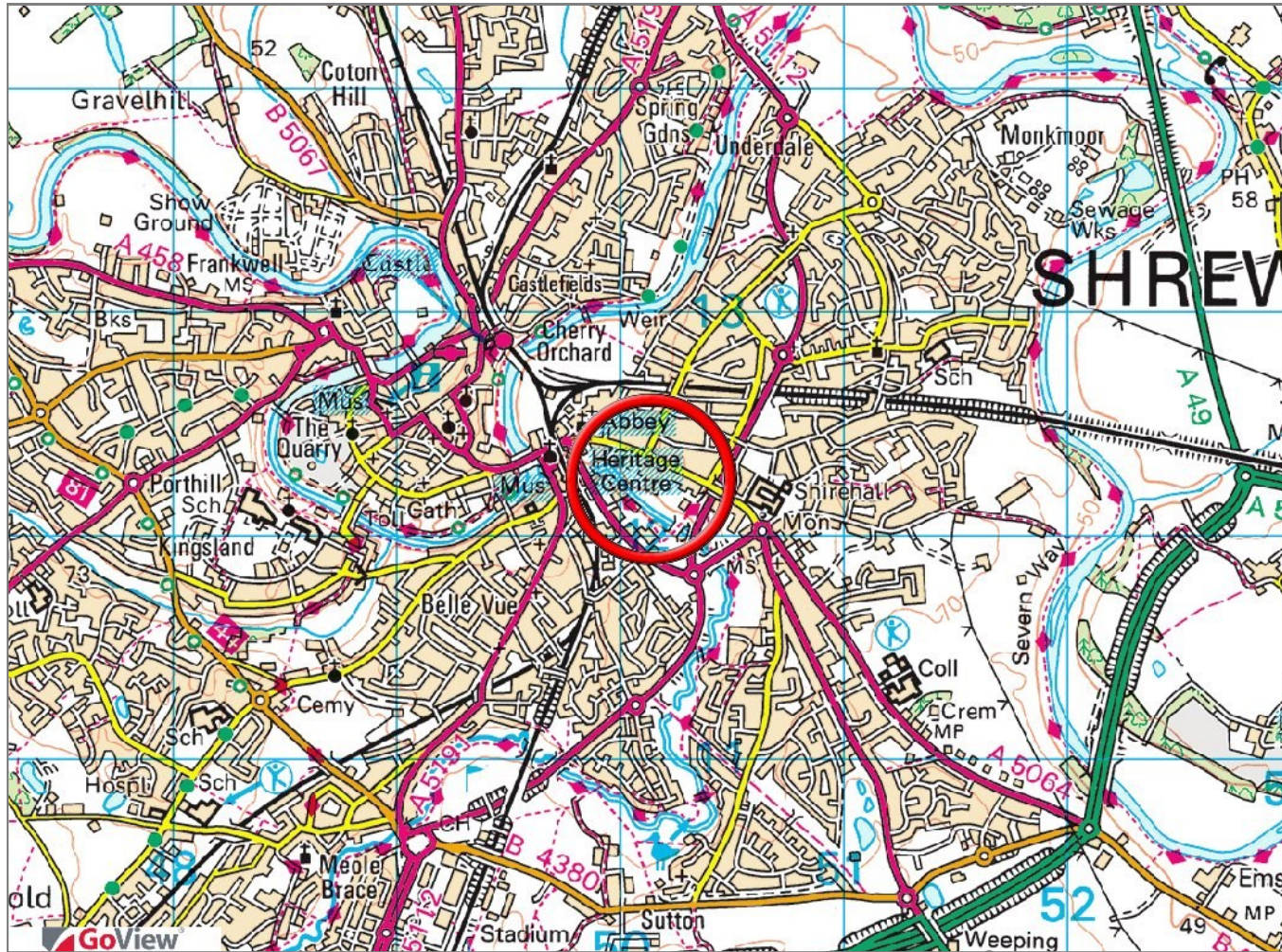

**IMPORTANT NOTICE:** Cooper Green Pooks for themselves and for the lessors or vendors of this property whose agents they are give notice that: 1 No appliances, services or service installations have been tested and no warranty as to suitability or serviceability is implied. Any prospective purchaser or lessee is advised to obtain verification from their surveyor or solicitor. 2. The particulars are set out as a general outline only for the guidance of the intended purchasers or lessees and do not constitute, nor constitute part of, an offer or contract. 3. All descriptions, reference to condition and necessary permissions for use and occupation and other details are given in good faith and are believed to be correct but any intending purchasers or lessees should not rely on them as statements or representation of fact but satisfy themselves by inspection or otherwise as to the correctness of each of them. 4. No person in the employment of Cooper Green Pooks has any authority to make or give any representation or warranty whatsoever in relation to this property. 5. All rentals and prices are quoted exclusive of Stamp Duty, legal and surveyors fees and any other associated purchasers or lessees costs. 6. Floor plans are indicative only and should not be relied on. 7. The plan showing the boundary of the property is indicative only and has not been checked against the legal title so should not be relied on. 8. All dimensions, floor areas and site areas are only approximate and should not be relied on. Dimensions are generally maximum room dimension.